

DWG. NO. 900-181-023

RoHS **CE**



NAME PLATE
(ENCODER TYPE)

NAME PLATE
(RATING INDICATION)

ENCODER

ENCODER
CONNECTOR

MOTOR
CONNECTOR

NAME PLATE
(NOTICE MARK)

DUST SEAL

DETAIL OF SHAFT EXTENSION

ENCODER TERMINAL
CONNECTION

MOTOR TERMINAL CONNECTION

1	PG5V
2	PG0V
3	FRAME GROUND
4	-
5	-
6	DATA (+)
7	DATA (-)
8	-
CON. CASE	FRAME GROUND

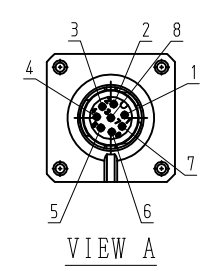

1	PHASE V
2	-
4	-
5	PHASE U
6	PHASE W
FG	FRAME GROUND
CON. CASE	FRAME GROUND

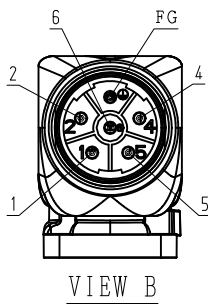

RECEPTACLE SIZE:M23
HOUSING:SF-5EP1N8AAD00S
MAKER:PHOENIX CONTACT

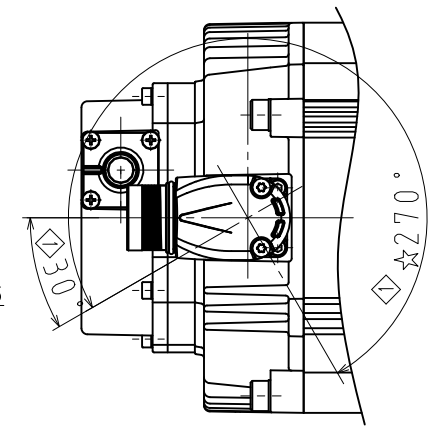

NOTES.

1. ALL DIMENSIONS ARE IN MILLIMETERS.
2. MOTOR SPECIFICATIONS :900-172-590
3. ENCODER SPECIFICATIONS:900-172-504 (24BIT INCREMENTAL)
4. VIBRATION : 15 μ m OR BELOW AT RATED SPEED.
5. PLUGS AND CABLE CLAMPS ARE OPTIONAL.
6. READ AND UNDERSTAND DOCUMENT PACKED WITH MOTOR (SAFETY PRECAUTIONS), AND BE CAREFUL USING MOTOR.
7. DEGREES OF PROTECTION:IP67 EXCEPT FOR SHAFT OPENING.
8. DO NOT TOUCH EACH OF CONNECTOR PINS DIRECTLY. IT CAUSE FAILURE.
9. IN CASE OF MOUNTING THIS MOTOR HORIZONTAL, TO PLACE THE CONNECTOR DOWN IS RECOMMENDABLE.
10. USE HEXAGON SOCKET HEAD CAP SCREWS FOR MOUNTING MOTOR.
11. MOTOR CONNECTOR COULD BE TURNED IN THE RANGE OF ☆ WITHIN 10 TIMES.

RECEPTACLE SIZE:M12
HOUSING:SACC-MSQ-M12MS
-25-3, 2 SCO
MAKER:PHOENIX CONTACT

TYPE	RATED OUTPUT kW	RATED TORQUE N·m	TIME RATING	RATED SPEED min ⁻¹	VOLTAGE V _{rms}	RATED CURRENT A _{rms}	THERMAL CLASS	WEIGHT kg	ALLOWABLE RADIAL LOAD F _r N	ALLOWABLE THRUST LOAD F _s N
SGM7G-09DFFKF	0.85	5.39	CONT.	1500	400 (3PHASE)	3.5	F	5.6	490 (AT SHAFT END)	98

3	Revised	15-07-07	H. KATO/T. HIROSE	SCALE 1 : 2.5	DRWN.	H. KATO	TITLE AC SERVOMOTOR Σ -7 SERIES SGM7G MODEL 0.85kW	DRWN. DATE	Jun. 06' 15	REV.	1
					CHKD.	T. HIROSE		DWG. NO.			
					APRV.	K. AOKI		900-181-023			

SIZE A3