

DWG.NO. HW2380826

User Cable Connector2:
M12 A-Coding 4 contacts (Socket)
Key Position:Upper Side

User Cable Connector1:
M8 A-Coding 8 contacts (Plug)
Key Position:Left-Lower Side

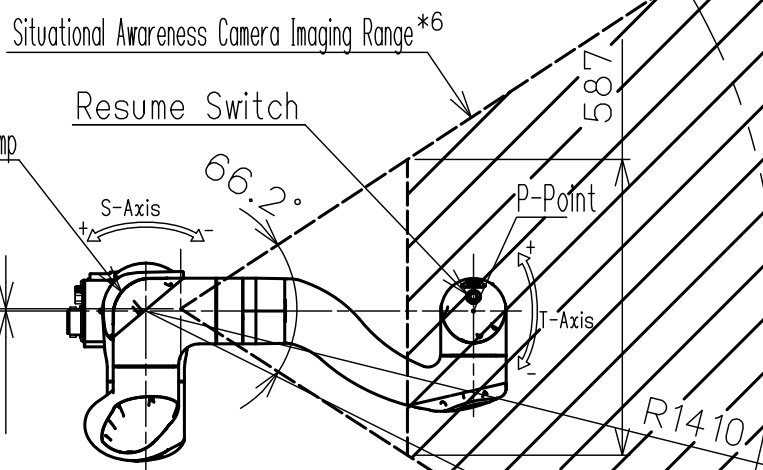

Type	Specification
YR-N1-06VXC12-A00	Standard model
*1 Repeatability conforms to ISO9283. *2 The manipulator is in the home position in this drawing. *3 When tilt- or wall-mounted, the S-axis motion range is limited. *4 The maximum speed value in this table is the available maximum value and will vary depending on the load, posture, or range of motion. *5 The power requirement value is obtained using YASKAWA's in-house measurement conditions and will vary depending on the load, motion pattern or cycle time. *6 The shaded area shows the overlap of the depth of field between the RGB camera and the depth camera.	

Item	Model	MOTOMAN NEXT-NHC12
Configuration		Vertically Articulated
Degree of Freedom		6
Payload		12kg
Repeatability*1		0.05mm
Range of Motion	S-Axis (Turning)*3	-210° - +210°
	L-Axis (Lower Arm)	-180° - +180°
	U-Axis (Upper Arm)	-73° - +253°
	R-Axis (Roll)	-210° - +210°
	B-Axis (Pitch/Yaw)	-90° - +270°
	T-Axis (Twist)	-210° - +210°
Maximum Speed*4	S-Axis	2.27rad/s, 130°/s
	L-Axis	2.27rad/s, 130°/s
	U-Axis	3.14rad/s, 180°/s
	R-Axis	3.14rad/s, 180°/s
	B-Axis	4.36rad/s, 250°/s
Allowable Moment	T-Axis	4.36rad/s, 250°/s
	R-Axis	30.0N·m (3.1kgf·m)
	B-Axis	30.0N·m (3.1kgf·m)
Allowable Inertia (GD ² /4)	T-Axis	11.0N·m (1.1kgf·m)
	R-Axis	0.94 kg·m ²
	B-Axis	0.94 kg·m ²
Mass		46kg
Protection Rating		All Axis:IP67
Mounting Method		Floor-,Wall-,Tilt-,Ceiling-mounted
Ambient Conditions	Temperature	0 °C - 40 °C
	Humidity	20%RH - 80%RH (Non-Condensing)
	Vibration Acceleration	4.9m/s ² (0.5G) or less
	Altitude	1000m or less
	Flatness for Installation	0.5mm or less
	Others	•Free from explosive and corrosive gas or liquid. •Free from excessive electrical noise (plasma). •Free from strong magnetic field.
Power Requirements *5		1.0kVA
Applicable Controller		YNX1000
Situational Awareness Camera	Resolution	1920x1200
	Field of View	40.3° (V) x66.2° (H) x73.6° (D) ±3°
	Depth of Field	RGB:0.45m - 1.32m Depth:0.40m - 1.50m

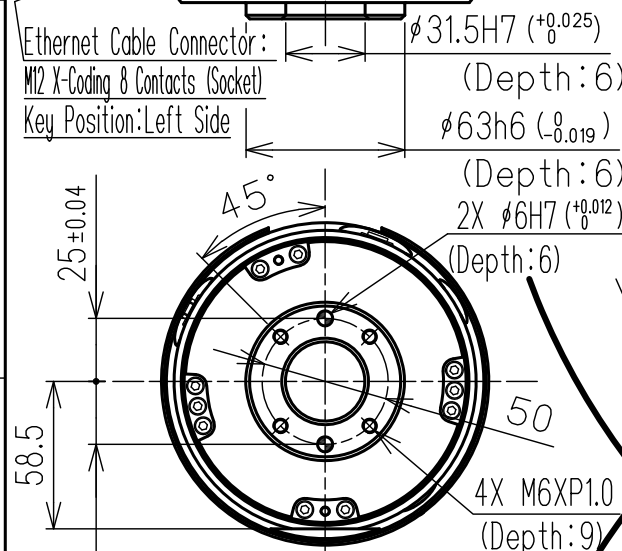

View C (Scale 1:3)

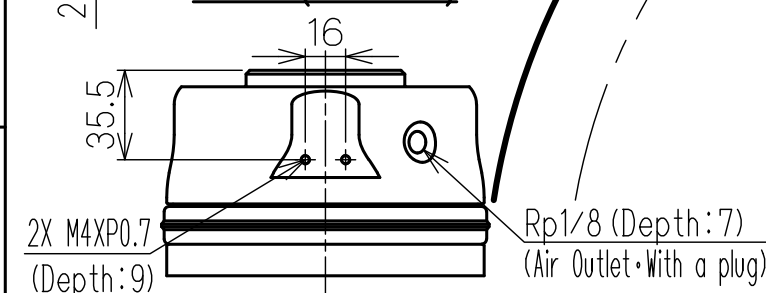

View B (Scale 1:3)

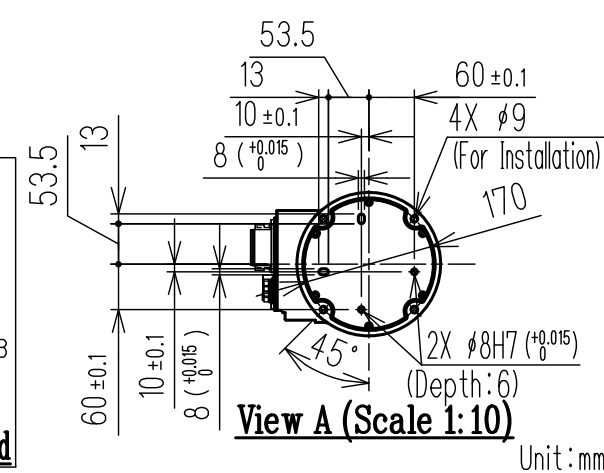
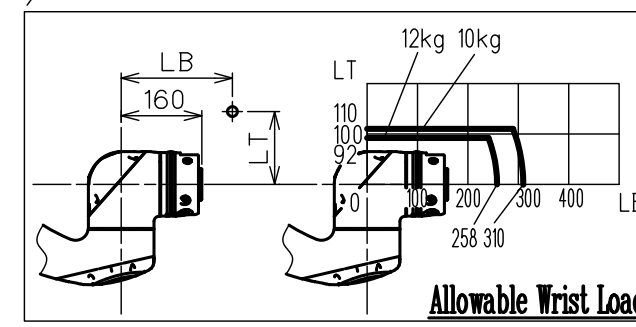
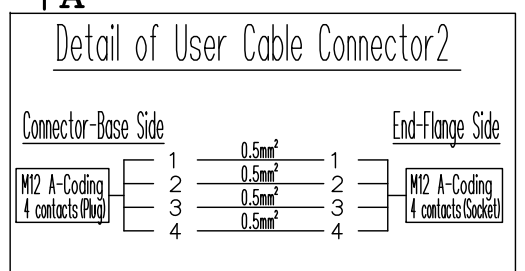
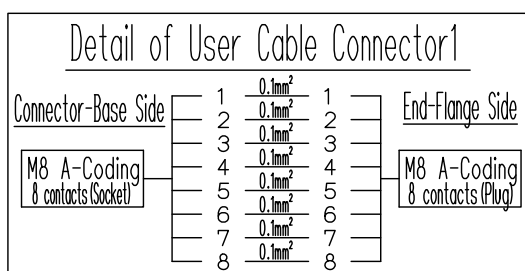
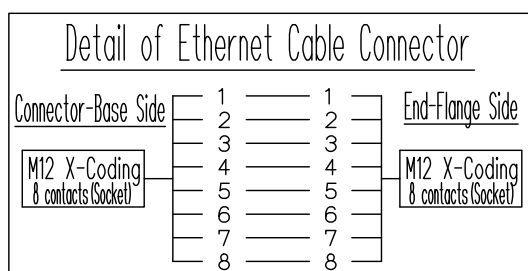
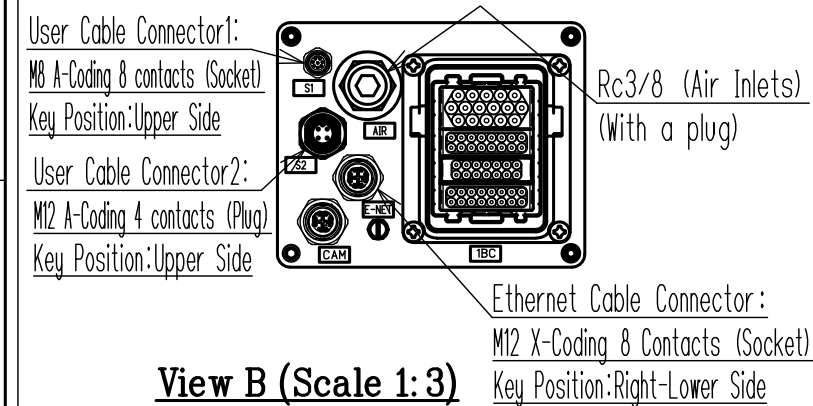

View A (Scale 1:10)

Note:
1.All rights reserved.
2.Please note that the data is subject to be deleted without advance notice.
3.No warranty is given in relation to the data including the specification.
4.We are not responsible for any damages or loss caused by the use of the data.

FOR STUDY PURPOSE ONLY

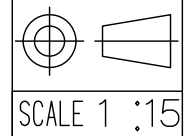

YASKAWA
株式会社 安川電機

Reference Drawing

TITLE MOTOMAN NEXT-NHC12
DIMENSION DIAGRAM

DRWN DATE Jan. 15, '25
DWG.NO. HW2380826
SIZE A 3